



**SUPA ONE™ UNIVERSAL
ONE-BOLT COUPLINGS**
STURDY SIMPLICITY

Expect... **AVK**



UNIVERSAL ONE-BOLT COUPLINGS ACCORDING TO EN 545 STURDY SIMPLICITY!

Supa One™ universal straight couplings and flange adaptors are very easy to install with only one bolt to be tightened in each end of the coupling and with the possibility of using a standard power tool. They are designed in ductile iron according to EN 545 to ensure sturdiness and durability. Available in DN 80-200.

Easy mounting

The bracket section can rotate 360° for adjustable bolt orientation during installation. This ensures full access to tightening the bolts, even when space is limited at the installation site.

The design of the spherical nuts allows them to rotate slightly and ensures a precise fit. Furthermore, the nuts are threaded to enable the use of a standard power tool to maximum 150 Nm, and the tool will not be pushed off by the rod end during tightening, which is often the case for traditional designs. There is no need for re-tightening of bolts.

The couplings are designed with a lifting eye on the sleeve enabling easy and ergonomically safe handling.

High-quality materials

- Bracket of ductile iron 450-10 with high strength, durability and elongation properties
- Gasket of drinking water approved EPDM rubber with a gasket bridge of stainless steel keeping the gasket in place
- Bolts of stainless steel A2 and nuts of A4 with anti-friction coating to prevent galling
- 250 µm fusion bonded epoxy coating in compliance with DIN 3476 part 1 and EN 14901, GSK approved



Flexibility during installation

Supa One™ couplings are suitable for all pipes and provide the possibility of connecting two different pipe materials. The couplings enable ±4° deflection in both ends (in total 8°), and the large insertion depth tolerances allow the pipe to be cut slightly angled. This gives a simple installation without need for precise adjustment.

"The Supa One™ coupling is very easy to install. The low weight is a noticeable advantage, and tightening with a standard power tool and torque wrench to 150 Nm works very well." - Kaare Mortensen A/S, Norwegian construction company.

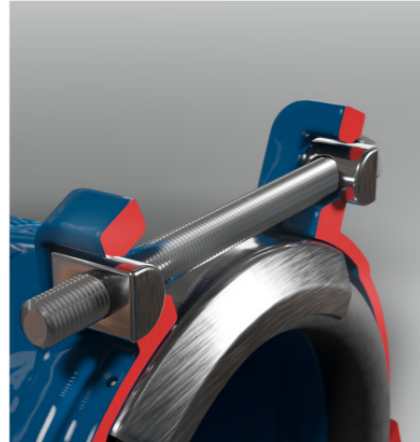

Item nos.	Type	DN mm	Product PN class	Tolerance mm	Kg
651-099-01-406400	Supa One™ straight coupling	80	PN16	88-99	13
651-119-01-406400	Supa One™ straight coupling	100	PN16	110-119	14
651-145-01-406400	Supa One™ straight coupling	125	PN16	139-145	17
651-171-01-406400	Supa One™ straight coupling	150	PN16	159-171	21
651-225-01-406400	Supa One™ straight coupling	200	PN16	216-225	28

Item nos.	Type	DN mm	Flange drilling	Tolerance mm	Kg
653-099-01-00406400	Supa One™ flange adaptor	80	10/16	88-99	9,3
653-119-01-00406400	Supa One™ flange adaptor	100	10/16	110-119	11
653-145-01-00406400	Supa One™ flange adaptor	125	10/16	139-145	13
653-171-01-00406400	Supa One™ flange adaptor	150	10/16	159-171	16
653-225-01-00406400	Supa One™ flange adaptor	200	10/16	216-225	22

AVK International A/S

Bizonvej 1
Skovby
8464 Galten
Denmark

Tel.: +45 8754 2100
www.avkvalves.eu

2024-01-26
Copyright © AVK Group A/S 2024

Expect... 